

# Packing List

The following items are included:



## DT12

Metal-Sheet Prefilter ..... 1 box

*Contains 2 filters*

0034799-141024

**JBC**

www.jbctools.com

# INSTRUCTION MANUAL



## DT12

### Metal-Sheet Prefilter for DT530

Before inserting the metal-sheet prefilter into the solder collector, bend it as shown on the right.

The metal filter is reusable. Loose solder residues can be wiped or brushed off. Flux residues can be removed with alcohol.

*Assembly sequence  
for spare parts:*

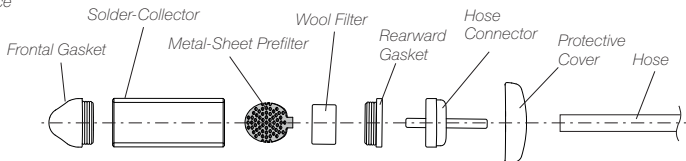

### Bending the Metal-Sheet Prefilter

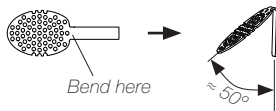

www.jbctools.com



# Prefilter Replacement

⚠ Be careful when manipulating the tool. The metal and glass parts may be hot.

## Detach the Solder Collector Group

Hold down the tool with one hand onto the stand (1) and grasp the suction hose at the point where it meets the protective cover and pull upward (2) to undock the solder-collector group from the heating element.

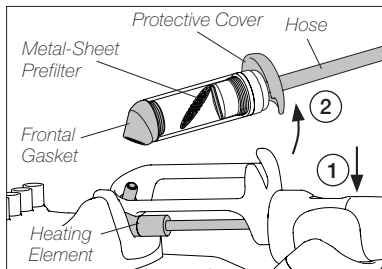

Then take the frontal gasket and the worn metal-sheet prefilter out. Clean it and reinsert it into the solder collector with its tab against the wool filter (3). If the prefilter is worn, replace it for a new one.

## Aligning the Components

Reinsert the front gasket and position it with its opening facing the same direction as the perforated prefilter side (4). Finally rotate the protective cover so, that its recess is pointing downwards (5).

