

# JBC

[www.jbctools.com](http://www.jbctools.com)

Product  
website



## INSTRUCTION MANUAL



## PDS

Portable Display 8" for B.IRON

This manual corresponds to the following references:

PDS-C

## Packing List

The following items are included:



**Portable Display 8"**  
**for B.IRON** ..... 1 unit

**Cable**  
**USB-A to USB-C** ..... 1 unit  
Ref. 0032705

**Manual** ..... 1 unit  
Ref. 0036848

## Features and Connections

PDS is designed to work with JBC's battery powered B.IRON station range.



## Features and Connections



\* Not included, sold separately.

## ESD Safe Connection

All B.IRON components comply with CE standards, but the tool by itself is not grounded. Therefore, to comply with ESD regulations, the user of a B.IRON tool must be ESD-compliantly grounded.

JBC offers ESD tablemats, earthing cables, plugs and wristbands. More info at [www.jbctools.com](http://www.jbctools.com).

## Station Setup

### Assemble the Display Holder

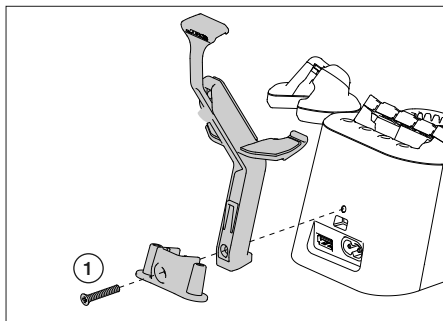

Align the display holder components as shown in the image and screw them to the charging base using the supplied DIN965 screw (1).

### Release the Display Holder's Tab

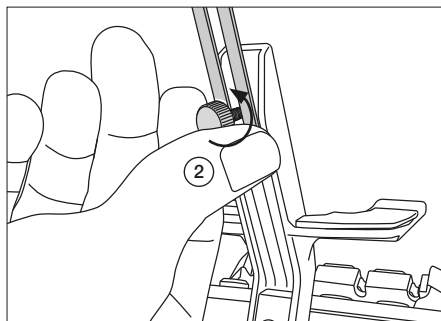

Loosen the fixing knob (2) enough so that the display holder tab can slide along the rear rail.

### Place the Display

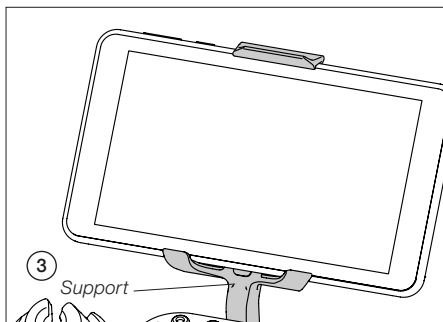

Place the display on the support (3). Adjust the height of the display holder tab and tighten the fixing knob.

### Plug in the Charging Base

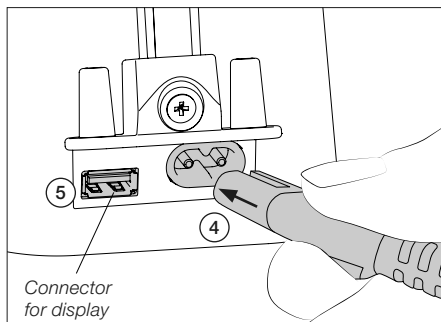

Connect the charging base to the mains (3).

Your display can be connected to the USB port (4) to keep it charging while working.

On your display, open the B.IRON app:



## App Installation

On your **smartphone or tablet** (*Android / iOS*), go to the App Store/Play Store and search for “JBC B.IRON” on the search bar.

On **JBC’s portable display** (*Android*), the B.IRON app is already installed.

**Note:** Internet connection is required to download the app from the App Store or Google Play.

### For displays without Internet connection

(*Android only*)

Download JBC’s installer to another device with an Internet connection from JBC’s website: <https://www.jbctools.com/jbcsoftware.html>.



Then, connect the display to the device with the installer and enable file transfer on the USB preferences of the display (swipe down from the top of the screen and tap on the notification from Android System).

Copy the installer to the internal storage of the display on Files > Internal storage > JBC (create folder if non-existent). Access the folder named JBC on the internal storage of the display and run the installer.

Alternatively, scan these QR codes to access the B.IRON app website:



## App Versions

Make sure that the required app version is installed on the display (tablet or smartphone) for compatibility reasons:

- B.100, B.500 and B.NANO require app versions **1.6** or higher.
- B.TWEEZERS requires app versions **1.7** or higher.

## App Update

### Display with Internet connection (*Android / iOS*)

Update through “App Settings” on the main menu of the app, Google Play (*Android*) or App Store (*iOS*).

### Display without Internet connection (*Android*)

Download JBC’s installer to another device with an Internet connection from JBC’s website: <https://www.jbctools.com/jbcsoftware.html>.



Then, connect the display to the device with the installer and enable file transfer on the USB preferences of the display (swipe down from the top of the screen and tap on the notification from Android System).

Copy the installer to the internal storage of the display on Files > Internal storage > JBC (create folder if non-existent). Access the folder named JBC on the internal storage of the display and run the installer. After the installer is completed, the app will be updated to the latest version.

# Accessories

## B.IRON Display Holder 10" to 13"

Ref. 0031246

In addition to the display holder supplied with the B.IRON station, JBC offers a holder for tablet sizes between 10" and 13".

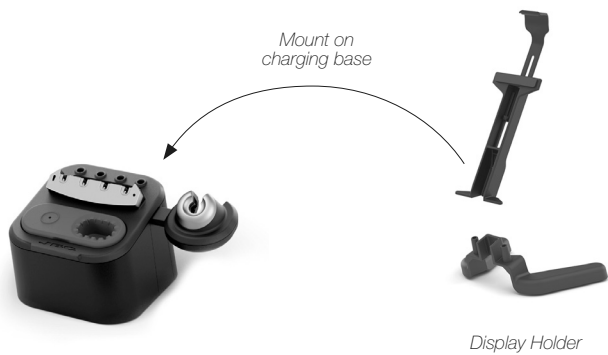

## Maintenance

- Charge the display under the following conditions:
  - Before its first use, to make sure the display is fully charged.
  - The battery power icon indicates “no power”.
  - The display automatically shuts off.
  - Operation buttons are not responsive.
- Do not disconnect the display during an ongoing upload or download process when the display is in file transfer mode. This could cause an app error.
- USB connection is used only for data transfer.
- Clean the display with a damp cloth. Do not use alcohol, thinner or benzene to clean it.
- Maintenance must not be carried out by children unless supervised.
- Repairs should be performed only by a JBC authorized technical service.

## Safety



**It is imperative to follow safety guidelines to prevent mal function or accidents.**

- Do not expose the portable display to high temperatures, humidity or dust. Avoid direct sunlight.
- Do not drop the portable display, as it may cause damage or malfunction.
- Do not use the portable display in places where wireless communications are restricted.
- Do not disassemble the display.
- The display is not waterproof.
- Keep your workplace clean and tidy. Wear appropriate protection when working to avoid personal harm.
- This appliance can be used by children over the age of eight and also people with reduced physical, sensory or mental capabilities or lack of experience, provided that they have been given adequate supervision or instruction concerning the use of the appliance and understand the hazards involved. Children must not play with the appliance.

## Specifications

### PDS

#### Portable Display 8" for B.IRON

Ref.: PDS-C

- Display Dimensions:	8.68 inches
- Connectivity:	Bluetooth 5.0
- Battery:	Li-Ion 3.7 V / 5000 mAh
- Total Net Weight:	375 g / 0.83 lb
- Total Package Dimensions/Weight:	245 x 185 x 45 mm / 760 g
(L x W x H)	9.65 x 7.28 x 1.77 in / 1.68 lb

Complies with CE standards.

ESD Safe (to comply with ESD requirements, see page 3).

# JBC

### Warranty

JBC's 2 year warranty covers this equipment against all manufacturing defects, including the replacement of defective parts and labor.

Warranty does not cover product wear or misuse.

In order for the warranty to be valid, equipment must be returned, postage paid, to the dealer where it was purchased.

**Get 1 extra year JBC warranty by registering here:**

**<https://www.jbctools.com/productregistration/>**

**within 30 days of purchase.**

If you register, you will receive e-mail notifications about new software updates for your registered product.



This product should not be thrown in the garbage.

In accordance with the European directive 2012/19/EU, electronic equipment at the end of its life must be collected and returned to an authorized recycling facility.



[www.jbctools.com](http://www.jbctools.com)