



JTSE

Power Hot Air Station

This Plug & Play Guide corresponds to the following references:

Ref.

JTSE-9B (100 V)
JTSE-1B (120 V)
JTSE-2B (230 V)

Station

More Information at the
product web page



Video Guide

Watch the
product video



Packing List

The following items are included according purchased station reference:



JTSE
Hot Air Control Unit 1 unit
 Ref. JTSE-9UA (100 V)
 Ref. JTSE-1UA (120 V)
 Ref. JTSE-2UA (230 V)



JTS
Stand 1 unit
 Ref. JT-SF



JTT
Heater Hose Set 1 unit
 Ref. JT-T1A (100V / 120V)
 Ref. JT-T2A (230V)



JN2015
JTT Bent Nozzle Ø 4 mm - 18 ° 1 unit
 Ref. JN2015



JN2012
JTT Bent Nozzle Ø 6 mm - 18 ° 1 unit
 Ref. JN2012



JN2020
JTT Straight Nozzle Ø 8 mm 1 unit
 Ref. JN2020



PH217
Kapton Tape 1 unit
 Ref. PH217



PH218
Thermocouple Type K1 unit
 Ref. PH218



ESHT
Magazine for Protectors & Extractors 1 unit
 Ref. ESHT-A

Installation



JTS
 Stand for JTT
 Heater Hose Set

JTSE
 Power Hot Air
 Control Unit



Power Cord
 included in JTSE Control Unit

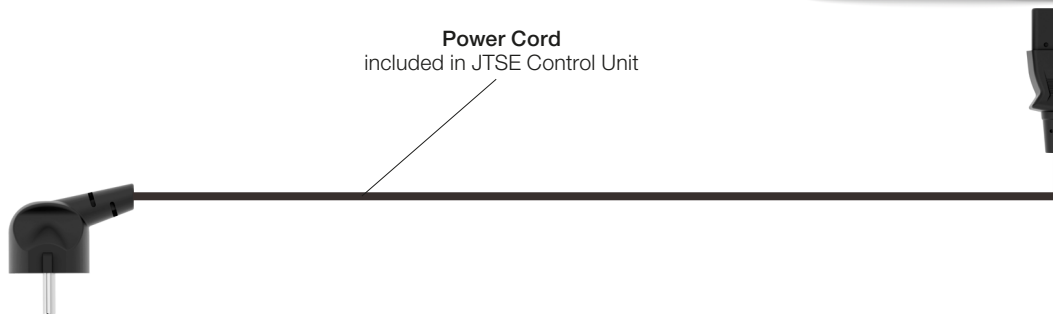

Installation

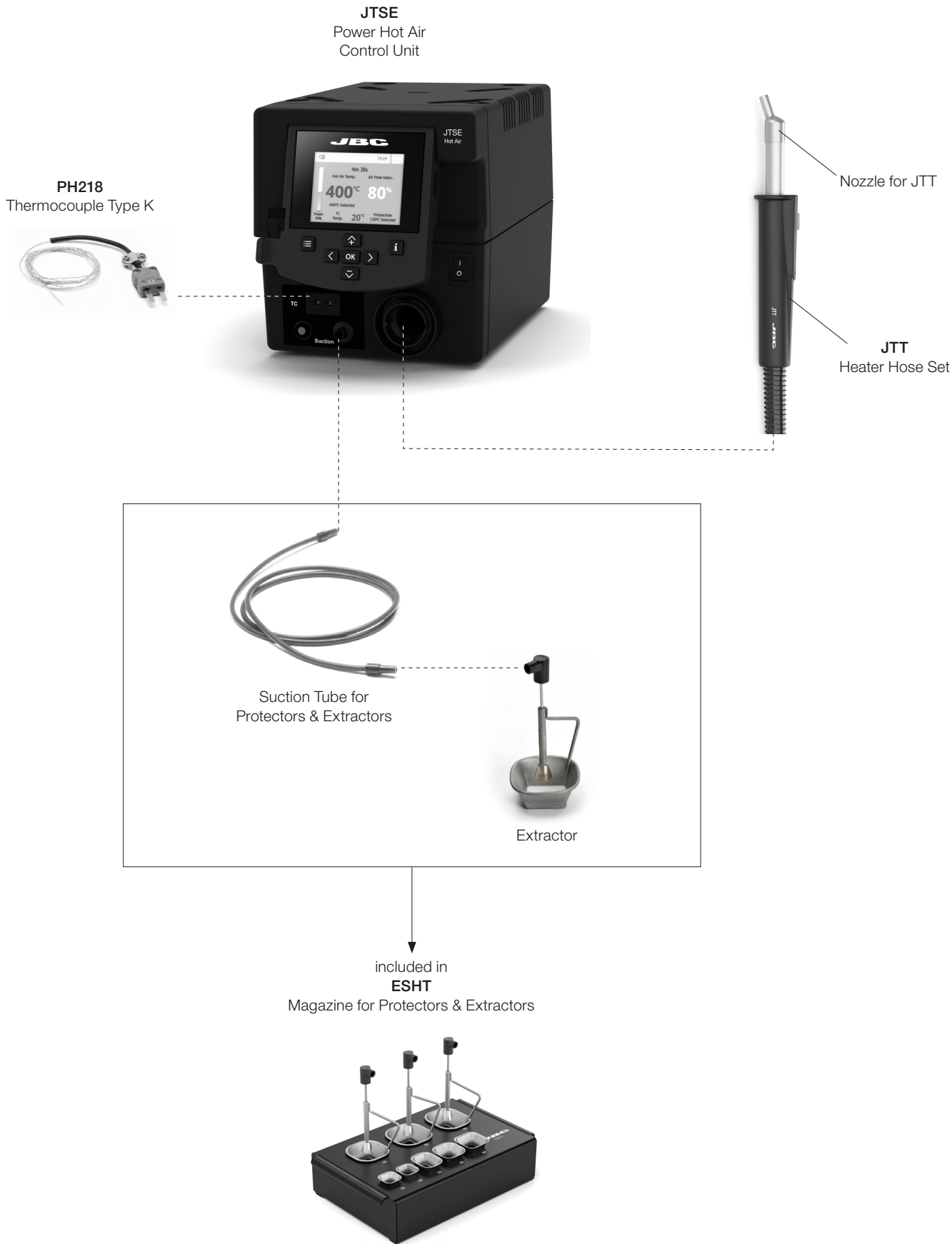

Specifications

JTSE

Power Hot Air Station

Ref. **JTSE-9B** (100 V) 50/60Hz. Input fuse: 8A. Rated current: 7A

Ref. **JTSE-1B** (120 V) 50/60Hz. Input fuse: 8A. Rated current: 7A

Ref. **JTSE-2B** (230 V) 50/60Hz. Input fuse: 4A. Rated current: 3A

- Package Dimensions / Weight:	545 x 345 x 275 mm / 7.89 kg
(L x H x W)	21.5 x 16.6 x 10.8 in / 17.39 lb

Complies with CE standards.

ESD safe.

JBC

Warranty

Information regarding the warranty of each product can be found on the final page of its instruction manual.



This product should not be thrown in the garbage.

In accordance with the European directive 2012/19/EU, electronic equipment at the end of its life must be collected and returned to an authorized recycling facility.

www.jbctools.com

0031284-190924